

Manor

TECH SPECS

September 2020



Manor technical information

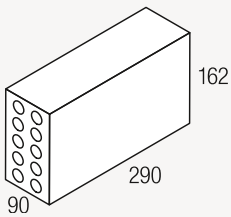

Finishing Brick
290x90x162mm
Not available in all products.

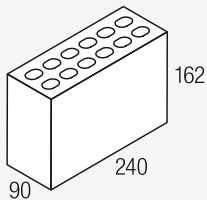

240mm Fraction Snap
240x90x162mm
Used to achieve half bond as the corner brick on each course.

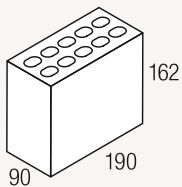

190mm Fraction Snap
190x90x162mm

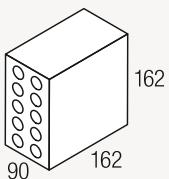

162mm Fraction Snap
162x90x162mm

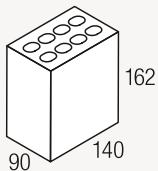

140mm Fraction Snap
140x90x162mm
Used to achieve bond on door or window reveals.

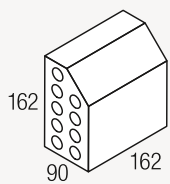

Sill Snap
162x90x162mm
One of the available sill options.

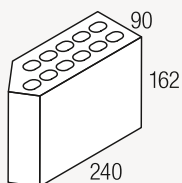

45° Squint
240x90x162mm

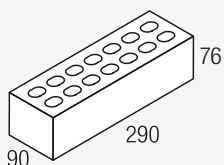

76mm Cored
290x90x76mm

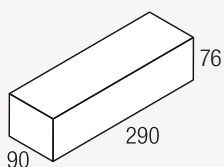

76mm Solid
290x90x76mm
Used as capping brick or under doors.

Design

To eliminate potential on-site problems your home or project should be designed to accommodate the brick's unique dimensions.
Size: 290x90x162mm, approximately 19.5 bricks to the square metre.

Bonding

Either one third or half bond can be used. One third bond requires less cutting. To achieve half bond use the 240mm fraction as the corner brick on each course.

Physical properties – Manor Range

Nominal Dimensions (mm)	Length 290 Width 90 Height 162
Dimensional Category	DW1
Dimensional Deviation (mm)	Length ±100 Width ±50 Height ±90
<i>Dimensional deviation measured over 20 bricks in accordance with Australian/New Zealand Standard AS/NZS 4456.3, Determining Dimensions.</i>	
Approximate Unit Weight (kg)	5.9
Characteristic Unconfined Compressive Strength (MPa)	>10
*Cold Water Absorption (%)	<12
Dry Density (kg/m ³)	>1,400
Durability Class	General Purpose
Coefficient of Expansion (mm/m)	<0.6
Liability to Efflorescence	Slight to Moderate

Note: All testing is carried out in accordance with Australian Standards AS/NZS4456 test methods where applicable. Testing is carried out in Midland Brick Company NATA accredited laboratory (Reg. No. 1637). Durability classification based on product knowledge under local (Perth) climate conditions. This technical information represents average properties obtained from production lots and should not be used for specification purposes. For more detailed specification contact Midland Brick. Unit weight quoted is an approximate weight and can vary. This information is subject to change without notice.

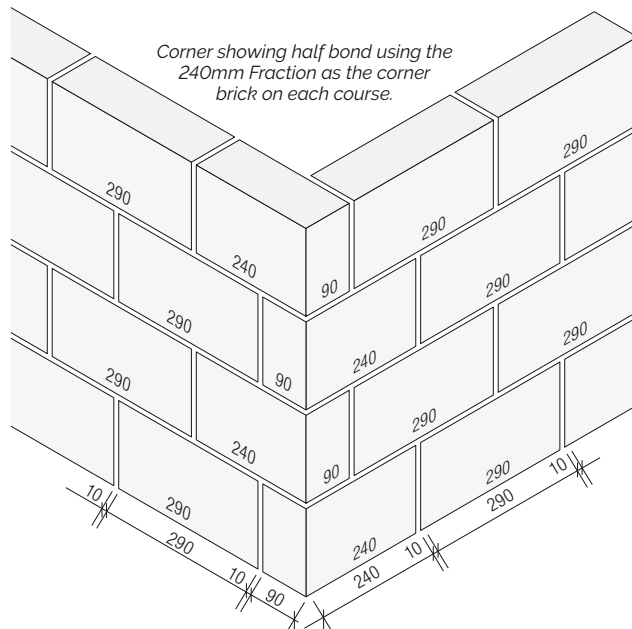

Manor technical information

Two course step down

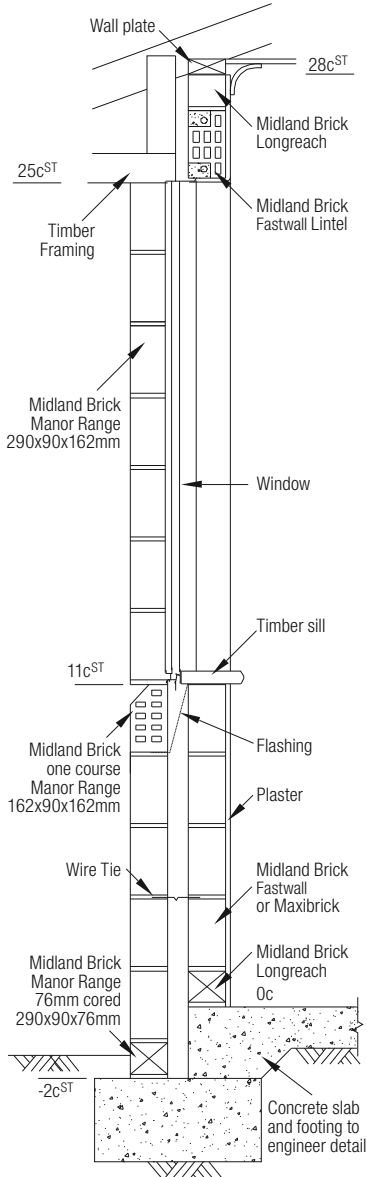

Note: Damp proof course to be installed in accordance with BCA requirements.

One third bond construction

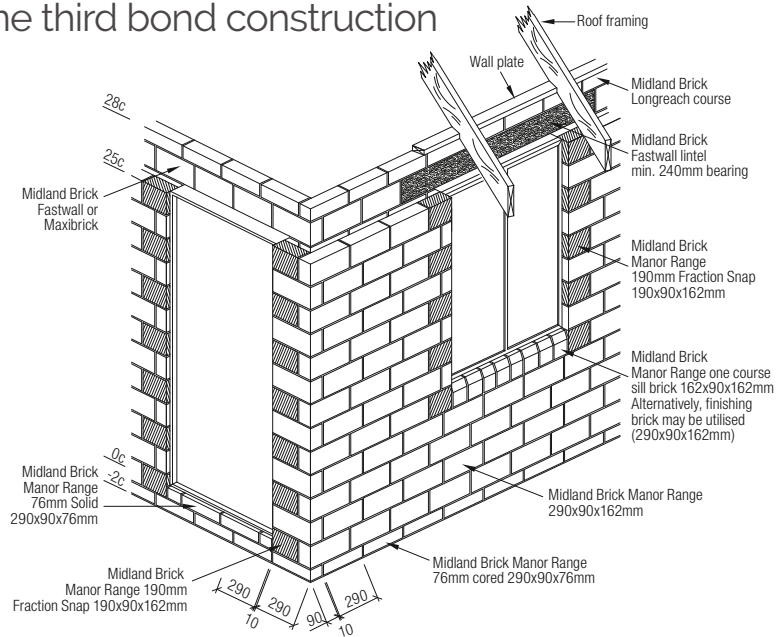

Half bond construction

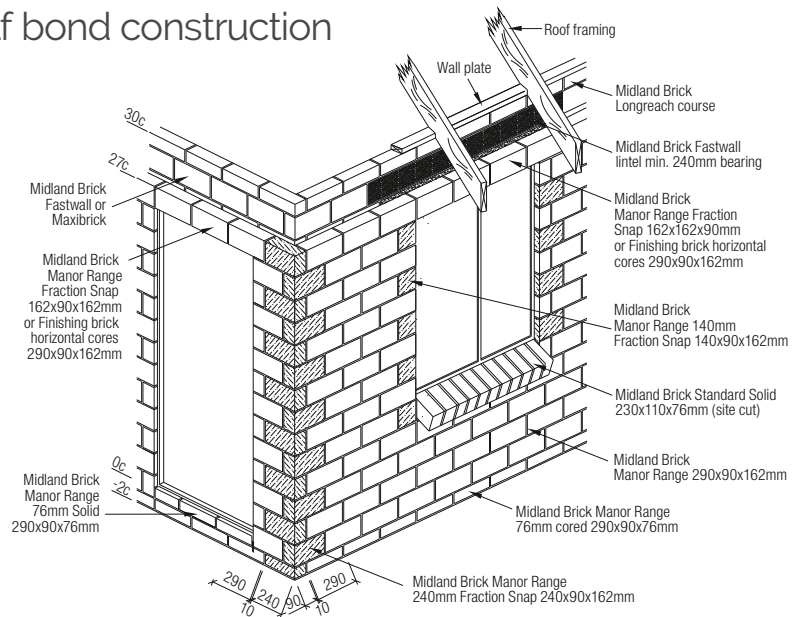

One third bond coursing chart

Design the project to suit the Manor Range dimensions.

FORMAT SIZE: 300x90x172mm
MANUFACTURING SIZE: 290x90x162mm

BRICKS PER m² IN WALL: 19.5 approx.
VERTICAL GAUGE: 7 Courses to 1200mm

Number of Bricks	Length mm	Opening mm	Height mm
1	290	310	172
1½	390	410	
1¾	490	510	
2	590	610	343
2½	690	710	
2¾	790	810	
3	890	910	514
3½	990	1010	
3¾	1090	1110	
4	1190	1210	686
4½	1290	1310	
4¾	1390	1410	
5	1490	1510	857

Number of Bricks	Length mm	Opening mm	Height mm
5½	1590	1610	
5¾	1690	1710	
6	1790	1810	1029
6½	1890	1910	
6¾	1990	2010	
7	2090	2110	1200
7½	2190	2210	
7¾	2290	2310	
8	2390	2410	1372
8½	2490	2510	
8¾	2590	2610	
9	2690	2710	1543
9½	2790	2810	

Number of Bricks	Length mm	Opening mm	Height mm
9¾	2890	2910	
10	2990	3010	1714
10½	3090	3110	
10¾	3190	3210	
11	3290	3310	1886
11½	3390	3410	
11¾	3490	3510	
12	3590	3610	2057
12½	3690	3710	
12¾	3790	3810	
13	3890	3910	2229
13½	3990	4010	
13¾	4090	4110	

Number of Bricks	Length mm	Opening mm	Height mm
14	4190	4210	2400
14½	4290	4310	
14¾	4390	4410	
15	4490	4510	2572
15½	4590	4610	
15¾	4690	4710	
16	4790	4810	2743
16½	4890	4910	
16¾	4990	5010	
17	5090	5110	2914
17½	5190	5210	
17¾	5290	5310	
18	5390	5410	3086